

Begane grond
1:100

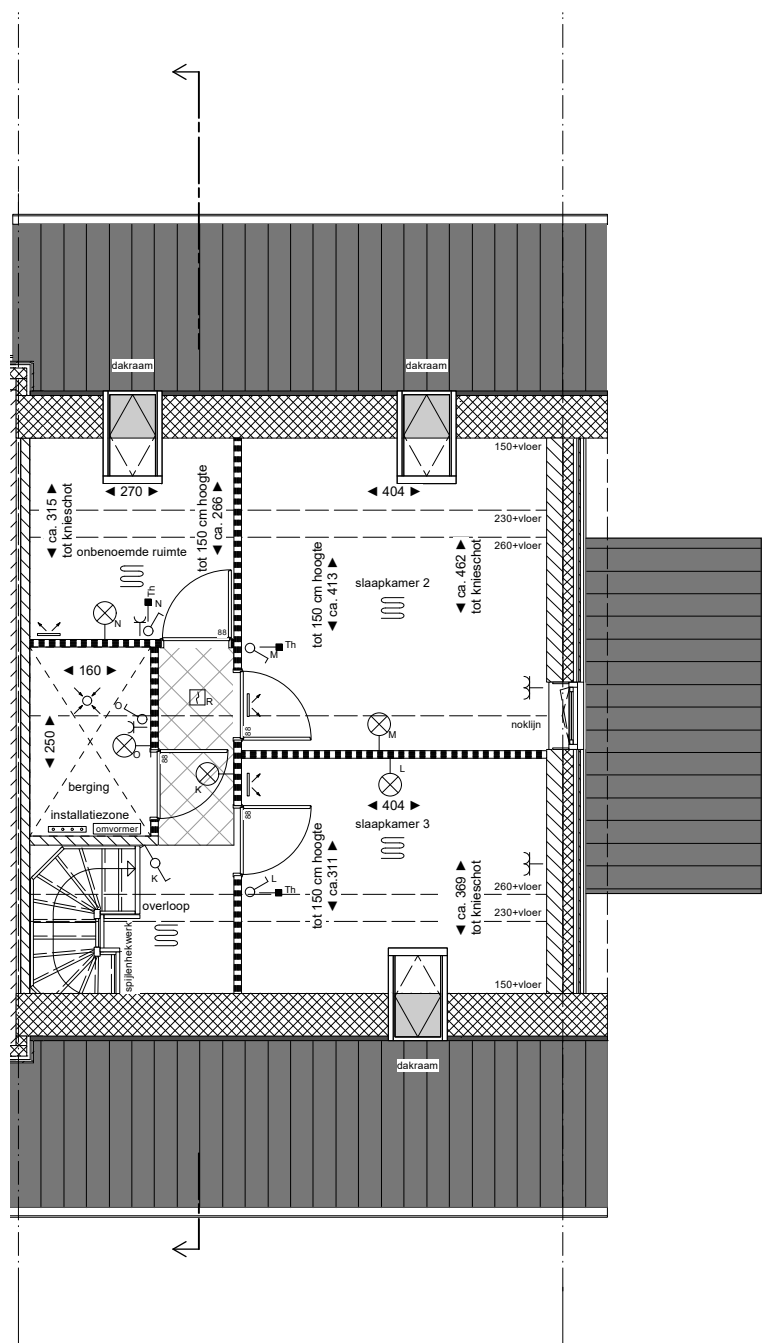



1e verdieping
1:100



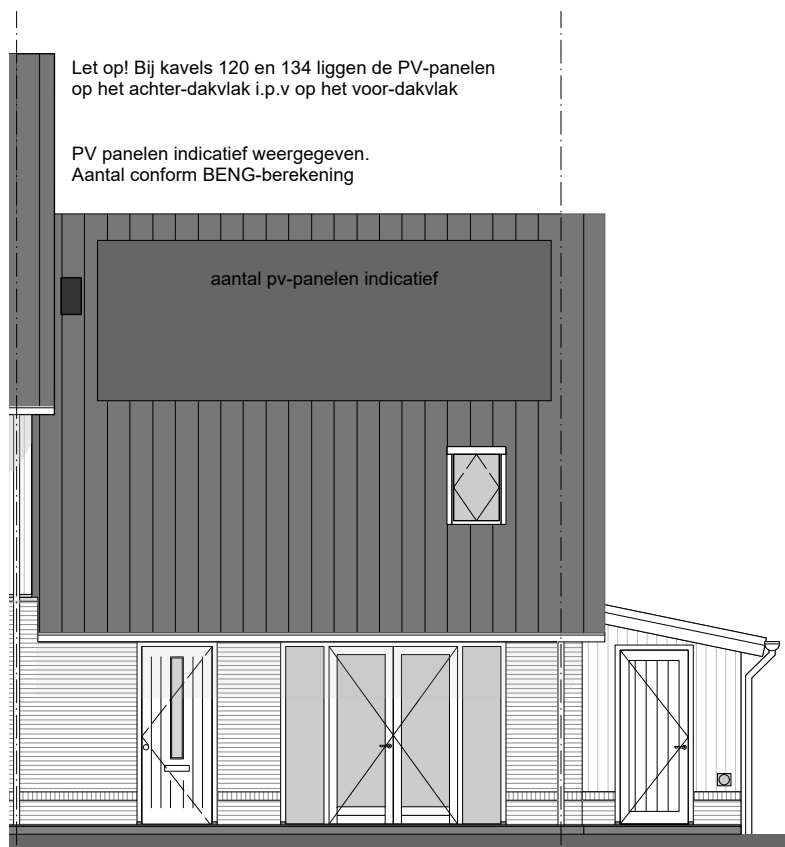

Voorgevel
1:100



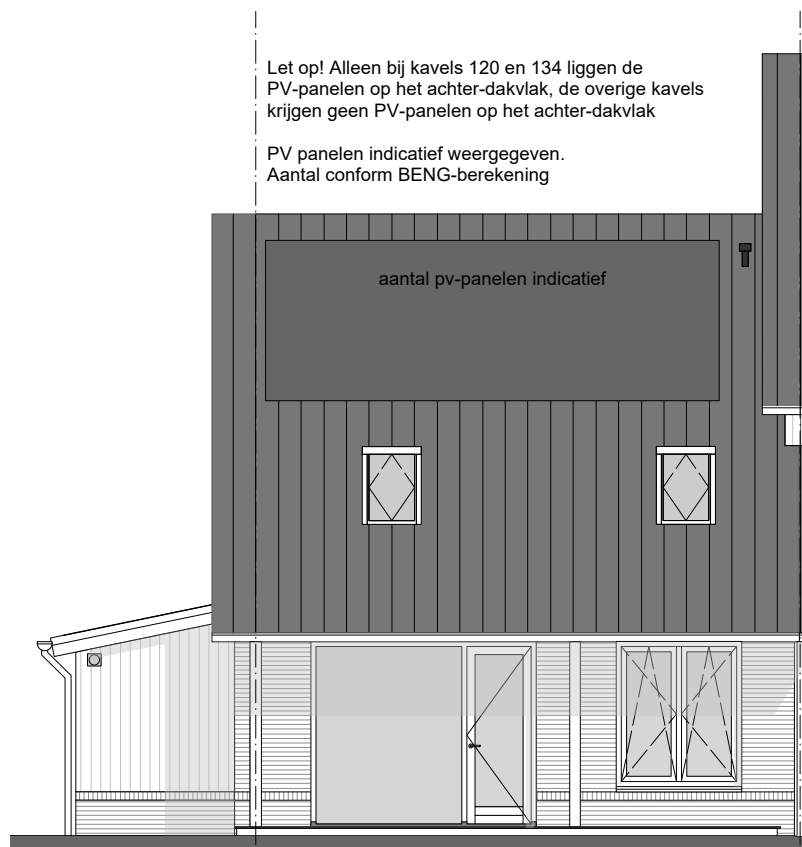

Achtergevel
1:100



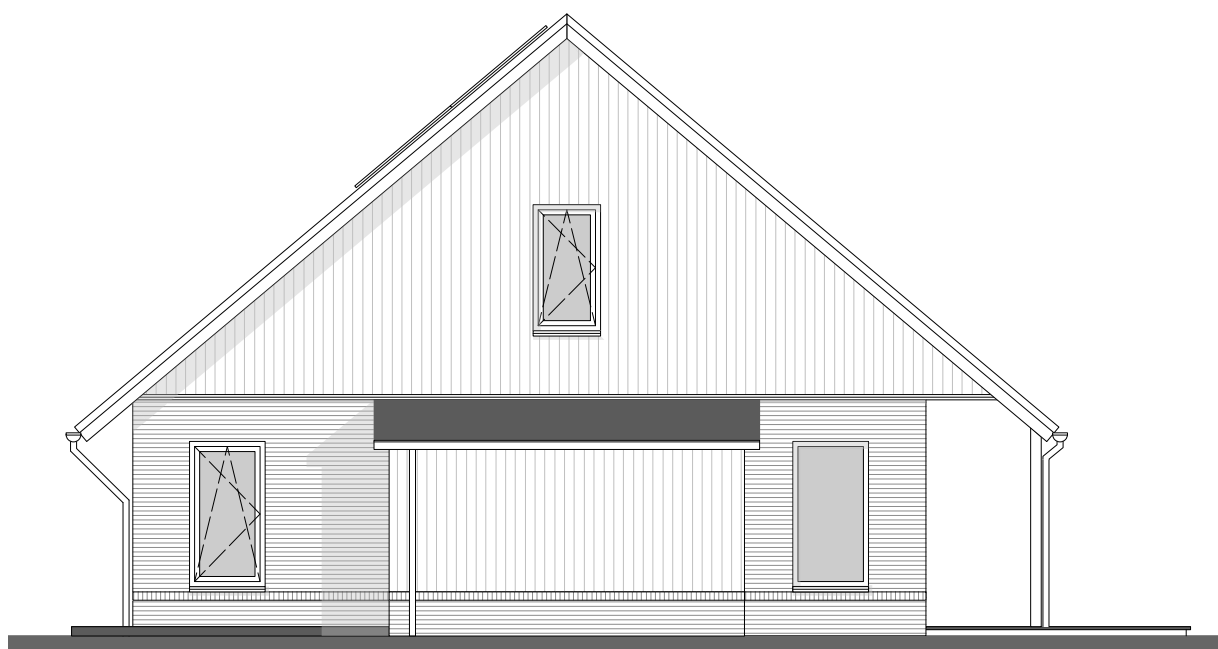

Zijgevel
1:100



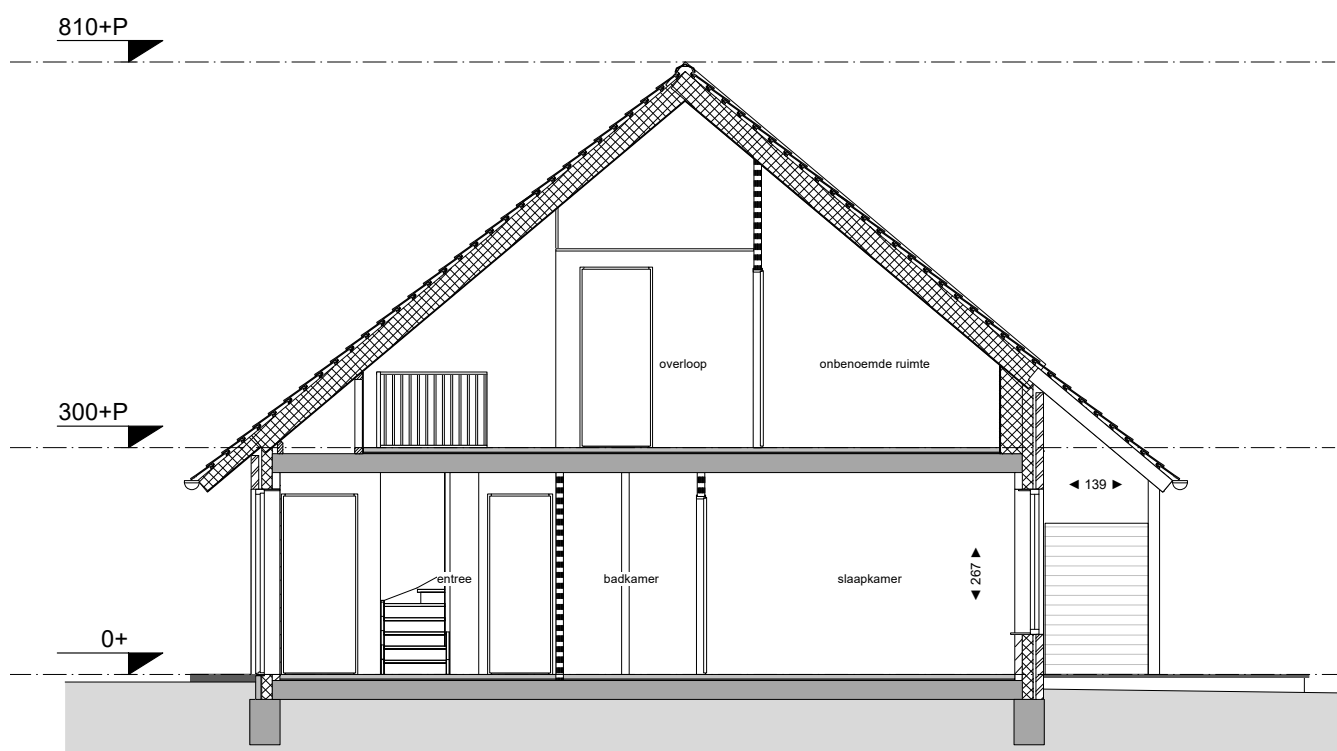





























Doorsnede
1:100



Renvooi elektrische installatie (NEN 1010)

	verdeelinrichting
	signaal bel
	beldrukker
	optische rookmelder
	indicatie positie toevoerpunt ventilatie
	indicatie positie afvoerpunt ventilatie
	indicatie positie wandtoevoerpunt ventilatie
	ruimte voorzien van vloerverwarming
	e-radiator
	omvormer pv-panelen
	verdeler vloerverwarming
	aansluitpunt data
	aansluitpunt niet bedraad
	thermostaat
	voedingskabel ten behoeve van de berging
	centraal aardpunt
	aarding
	aardmat
	centraaldoos met lichtpunt
	wandarmatuur
	wandlichtpunt
	schakelaar wtw-bediening
	schakelaar, 1-polig
	wisselschakelaar
	serieschakelaar
	contactdoos 1 fase, nul en beschermingscontact
	dubbele wandcontactdoos (opbouw)
	enkele wandcontactdoos
	dubbele wandcontactdoos (horizontaal geplaatst)

Renvooi

WM	opstelplaats wasmachine
WD	opstelplaats wasdroger
	lichte scheidingswand
	kalkzandsteen lijmblokken
	isolatie volgens BENG-berekeningen
	metselwerk volgens materiaalstaat
	douchedrain
	tegelwerk vloer
	verlaagd plafond
dB	geluidwerende deur
	gevelrooster

Algemeen

De maatvoering op tekening is indicatief en kan afwijken, maten in centimeters.
Indien deze maatvoering tussen wanden is aangegeven, is daarbij geen rekening gehouden met enige wandafwerking.
De netto bruikbare maten bij oplevering kunnen een aantal centimeters van de genoemde brutomaten afwijken.

De opstelling van de keuken en aansluitingen in de keuken volgens de standaard keukentekening van de keukenleverancier.

De aangegeven elektrapunten/ ventilatiepunten/ radiatoren/ knieschotten zijn indicatief.
De exacte plaats wordt nader bepaald door de installateur(s)/ keukenleverancier.

Dubbele tuindeuren (indien van toepassing) A= actieve deur P= passieve deur